

Kerb to Kerb

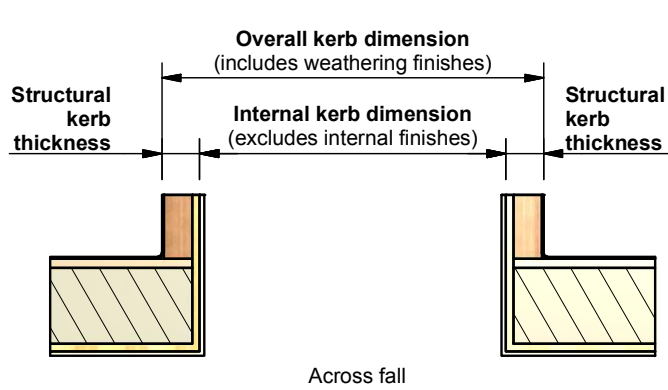

Across fall

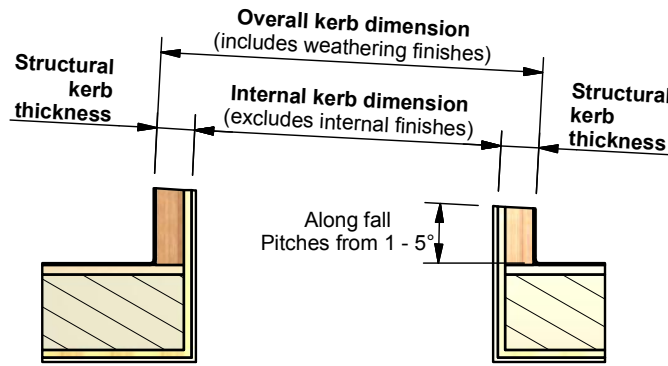

Along fall
Pitches from 1 - 5°

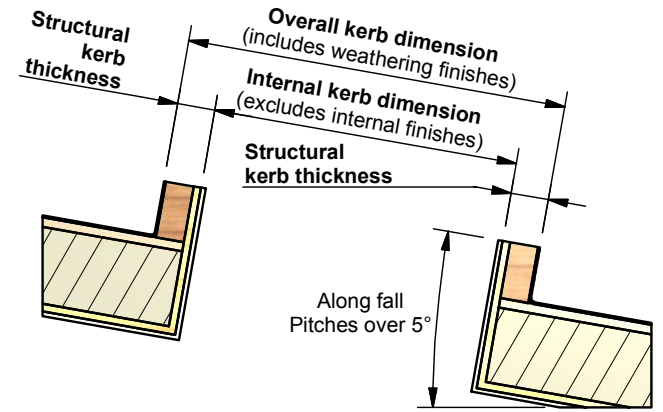

Along fall
Pitches over 5°

Wall to Kerb

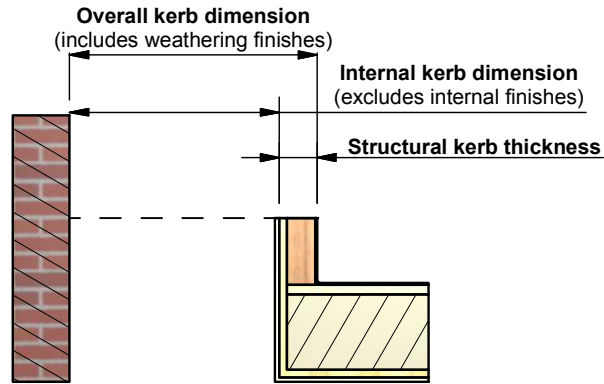

Across fall

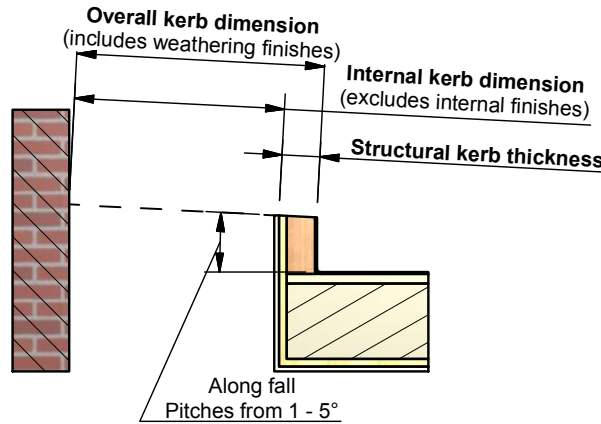

Along fall
Pitches from 1 - 5°

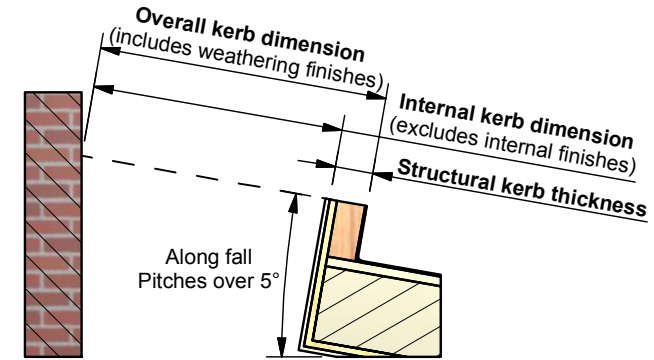

Along fall
Pitches over 5°

Wall to Wall

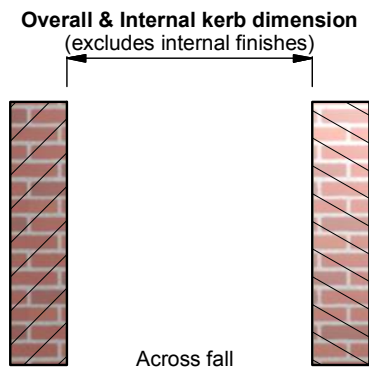

Across fall

The critical dimensions we require when ordering your rooflight

External kerb dimension; is a critical dimension for ensuring the rooflight's frame fits over the outside of the kerb.

Internal kerb dimension; is a critical dimension for ensuring internal details fit (e.g. glass fins on a Multipart Flushglaze). It is essential that internal finishes are applied after rooflight installation.

Structural kerb thickness; is a critical dimension for ensuring the rooflight is suitably supported and any internal frame details do not clash with the kerb (e.g. back-to-back support angles on a Multi-Part Flushglaze. Or manual crank handle on a Manual VisionVent).

PLEASE PASS THIS TO YOUR BUILDER
Builder to refer to order confirmation for required kerb sizes

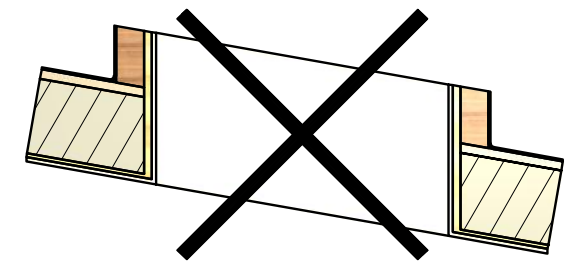

For pitches greater than 5 degrees, the pitch must be built into the roof. The kerb must be constructed perpendicular to the roof.



Saw Mills Road
Diss
Norfolk
IP22 4RG
Tel: +44 (0)333 8000 881
Fax: +44 (0)333 8000 882
Email: sales@glazing-vision.co.uk
Website: www.glazing-vision.co.uk

IT IS GLAZING VISION'S POLICY TO CONTINUOUSLY DEVELOP AND IMPROVE OUR PRODUCTS. AND THEREFORE RESERVE THE RIGHT TO MODIFY OR CHANGE THE DETAIL DESIGN AT OUR DISCRETION AND WITHOUT PRIOR NOTICE. THIS DRAWING IS COPYRIGHT AND THE SOLE PROPERTY OF GLAZING VISION LTD. THE DESIGNS/INFORMATION IT CONTAINS ARE PRIVATE AND CONFIDENTIAL. IT MUST NOT BE COPIED, EXHIBITED OR COMMUNICATED TO THIRD PARTIES FOR ANY PURPOSE OTHER THAN THAT FOR WHICH IT WAS ISSUED WITHOUT THEIR WRITTEN PERMISSION.

Third angle projection unless otherwise noted.
Tolerances:
Whole numbers = ±1mm
One decimal place = ±0.5mm
Two decimal places = ±0.2mm
Angular = ±0.5 degree
IF IN DOUBT - ASK! DO NOT SCALE
Supplier to deburr & remove sharp corners

Rev	Revision Description	Drawn/Date
A	Amended contact numbers	JOB 19/2/2010
B	Reproduced in Inventor, amended layout, updated to new Diss address	PGW 20/1/2011

Product: Standard Products	Checked By:
Description: Kerb dimensioning information for Standard Products (1 of 2)	
Materials: N/A	Check Date:
Finish: N/A	
Weight: N/A	Drawn By: peterw
Quantity: N/A	Drawn Date: 19/01/2011
Scale: N/A	Drawing No: S0009